



## SYSTEM CASES WAGNER RAIL

### Tools for

- Maintenance
- Commissioning of fire alarm, fire-fighting and fire-extinguishing technology

# OVERVIEW

## Tools for air sampling smoke detectors

Test kit TITANUS <i>MICRO·SENS</i> ® – detection unit	RL-50-0001	4
Leakage test kit – air sampling hose system	RL-50-0002	5
Cleaning kit version 1 – air sampling hose system	RL-50-0003	6
Cleaning kit version 2 – air sampling hose system	RL-50-0019	6
Commissioning and maintenance kit	RL-50-0010	7

## Tools for fire fighting/fire extinguishing

Test kit fire control system	RL-50-0015	8
Test adapter types A–E		9

## Accessories and spare parts

Accessories		9
Spare parts		10

# INTRODUCTION

Dear customers and partners of WAGNER Rail,

in this brochure we would like to introduce our portfolio of service kits to you, which you will need for the commissioning and maintenance of WAGNER fire protection products.

Our customers always expect from us individual solutions tailored to their specific needs and requirements. So it goes without saying that we will assist you with the service and maintenance tasks of our technology and provide you with suitable equipment. On the following pages you will find everything you need for the commissioning and testing of WAGNER Rail technology, rounded off by a collection of spare and wear parts.

We wish you every success in using our service kits and are always looking forward to receiving your feedback and suggestions: [info@wagner-rail.de](mailto:info@wagner-rail.de)

## ADVANTAGES:

- ✓ complete service equipment
- ✓ compact, space-saving and transport-optimised
- ✓ clearly arranged, everything within easy reach
- ✓ documentation included

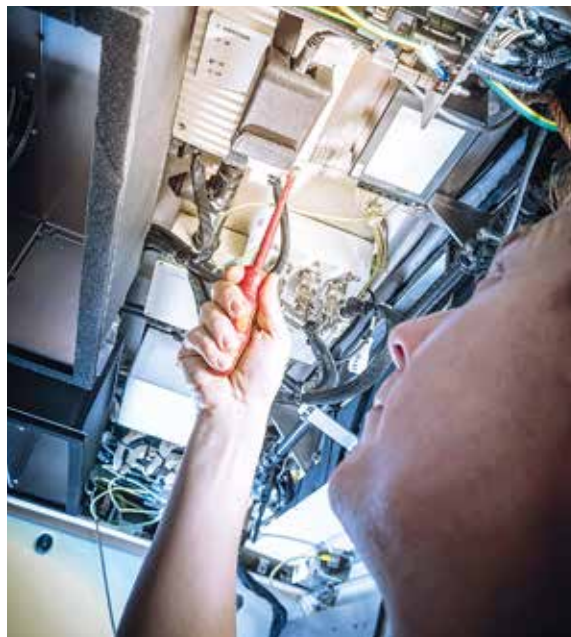

## TEST KIT TITANUS *MICRO·SENS*® – DETECTION UNIT

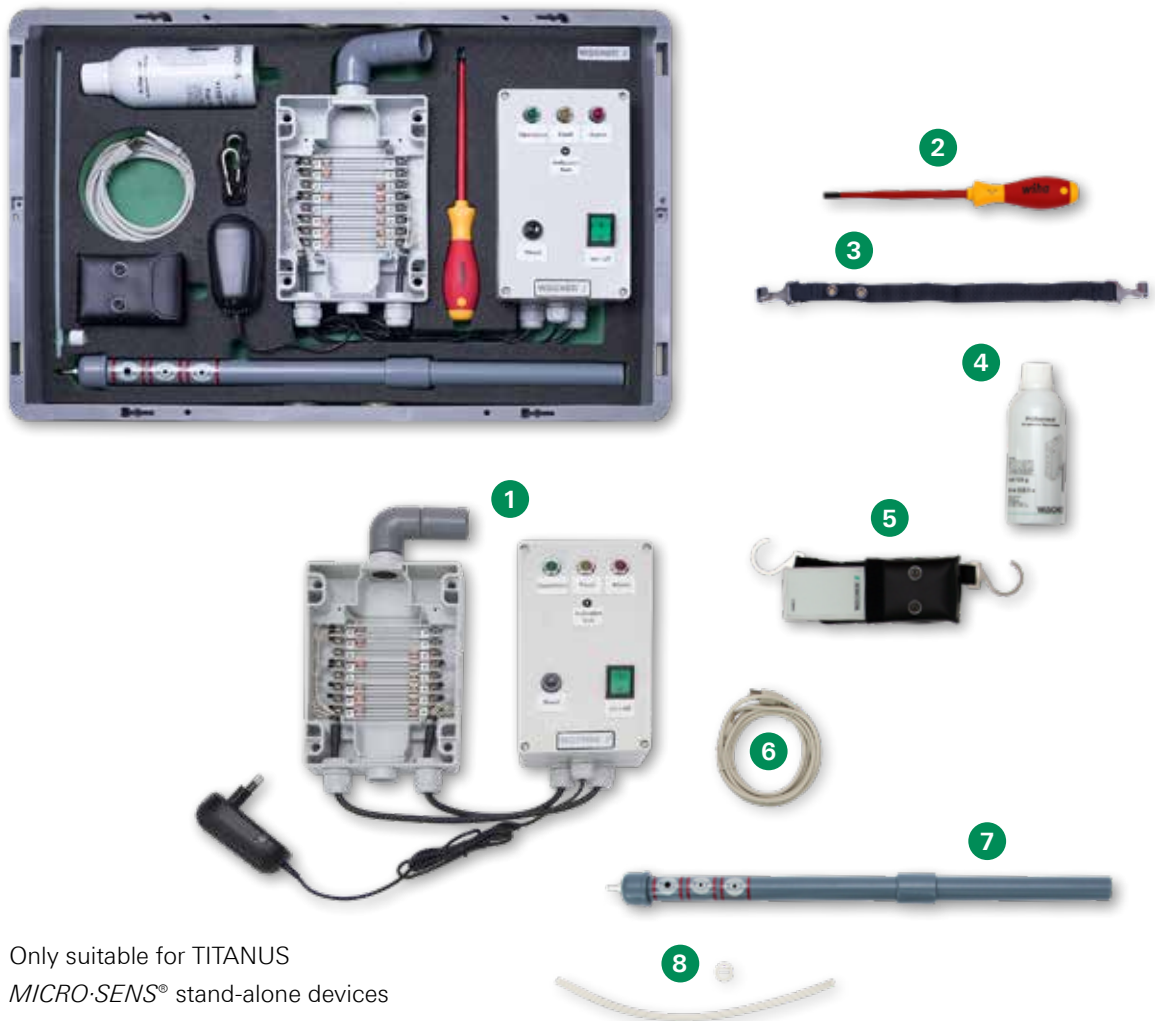

Only suitable for TITANUS  
*MICRO·SENS*® stand-alone devices

**Requirement:** euro connection, 230 V

The test kit for the TITANUS *MICRO·SENS*® detection unit is used to check the standard displays and functions of the detection unit. It is suitable for devices with connection to higher-level systems by means of potential-free contacts. For this, alarm and fault situations are simulated and the display of the messages is checked both on the TITANUS® itself and on the DIAG 3/x diagnostic tool. It also checks whether

the relay that transmits the message is functioning properly.

### Part No.: RL-50-0001

- (1) *MICRO·SENS*® test unit
- (2) VDE slot screwdriver
- (3) Hook for fastening the diagnostic tools
- (4) Test aerosol
- (5) DIAG 3/x diagnostic tool, software included
- (6) USB cable for connection of DIAG-Tool with PC
- (7) Test tube
- (8) Accessories for the test tube



## LEAKAGE TEST KIT – AIR SAMPLING HOSE SYSTEM



The leakage test set is used to check an air sampling hose system for air sampling smoke detectors for leaks and for professional installation. An energy-independent vacuum measurement allows a quality check to be performed immediately after completing the installation before claddings or similar make access difficult or impossible. The enclosed tools enable immediate repair of damaged areas. The

leakage test must be performed during each installation (during commissioning at the latest) as well as during a conversion and, if necessary, after cleaning the air sampling hose system.

### Part No.: RL-50-0002

- (1) Test plug set, 3.0 mm (12x)
- (2) Hose scissors (1x)
- (3) Double stroke pump, type WRA (1x)
- (4) Test adapter for leakage test unit, blind coupling (1)
- (5) Adapter connection, 21.2 mm (1x)
- (6) Adapter connection, 28.5 mm (1x)
- (7) Compressed air hose, 5 m (2x)
- (8) Leakage test unit (1x)

### Optional supplementary set

#### Part No.: RL-50-0017

For leakage testing via an existing cleaning adapter in the hose system



## CLEANING KIT – AIR SAMPLING HOSE SYSTEM



The cleaning kit is used for cleaning the air sampling hose system as well as the corresponding air sampling orifices and air filters in an air sampling smoke detection system.

### Version 1:

#### Part No.: RL-50-0003

- (1) Replacement lids for test adapter (2x)
- (2) RohrFlex adapter 21.2 to M20 (1x)
- (3) Sensor air filter (10x)
- (4) Replacement kit for air filter inserts Rail (4x)
- (5) Special cleaning brushes 2.0/3.0/4.0 mm (2x each)
- (6) Vacuum cleaner adapter 21.2 to 28 mm (1x)
- (7) Vacuum cleaner adapter 21.2 to 32 mm (1x)

- (8) Vacuum cleaner adapter 28.5 to 28 mm (1x)

- (9) Vacuum cleaner adapter 28.5 to 32 mm (1x)

- (10) RohrFlex connecting hose 21.2/1x2 m (without illustration)

### Version 2:

#### Part No.: RL-50-0019

Same as version 1, except

- (11) Air filter cartridge (4x)

## COMMISSIONING AND MAINTENANCE KIT



**Requirement:** euro connection, 230 V

The commissioning kit for air sampling smoke detectors contains all components required for commissioning and maintenance of the air sampling smoke detector TITANUS®. The exact function of the individual components is explained in the corresponding technical descriptions.

### Part No.: RL-50-0010

- (1) Test aerosol – WAGNER (1x)
- (2) Test plug set, 3.0 mm (12x)
- (3) Screwdriver for opening the air sampling smoke detector and air filter (1x)
- (4) Accessories for the test tube (1x)
- (5) Test tube for air sampling smoke detector (1x)
- (6) Angle adapter 90° for test tube (1x)
- (7) Spare battery FlowCheck (1x)
- (8) Fog generator FlowCheck incl. battery (1x)
- (9) Charger FlowCheck (1x)
- (10) Country adapter (1x)
- (11) Charger for motor vehicle (1x)
- (12) Replacement fog cartridges (2x)
- (13) Replacement hose unit fog generator (2x)
- (14) Hook for fastening the diagnostic tools (2x)
- (15) DIAG 3/x diagnostic tool, software included (1x)
- (16) USB cable for connection of DIAG-Tool with PC (1x)

## TEST KIT FIRE CONTROL SYSTEM

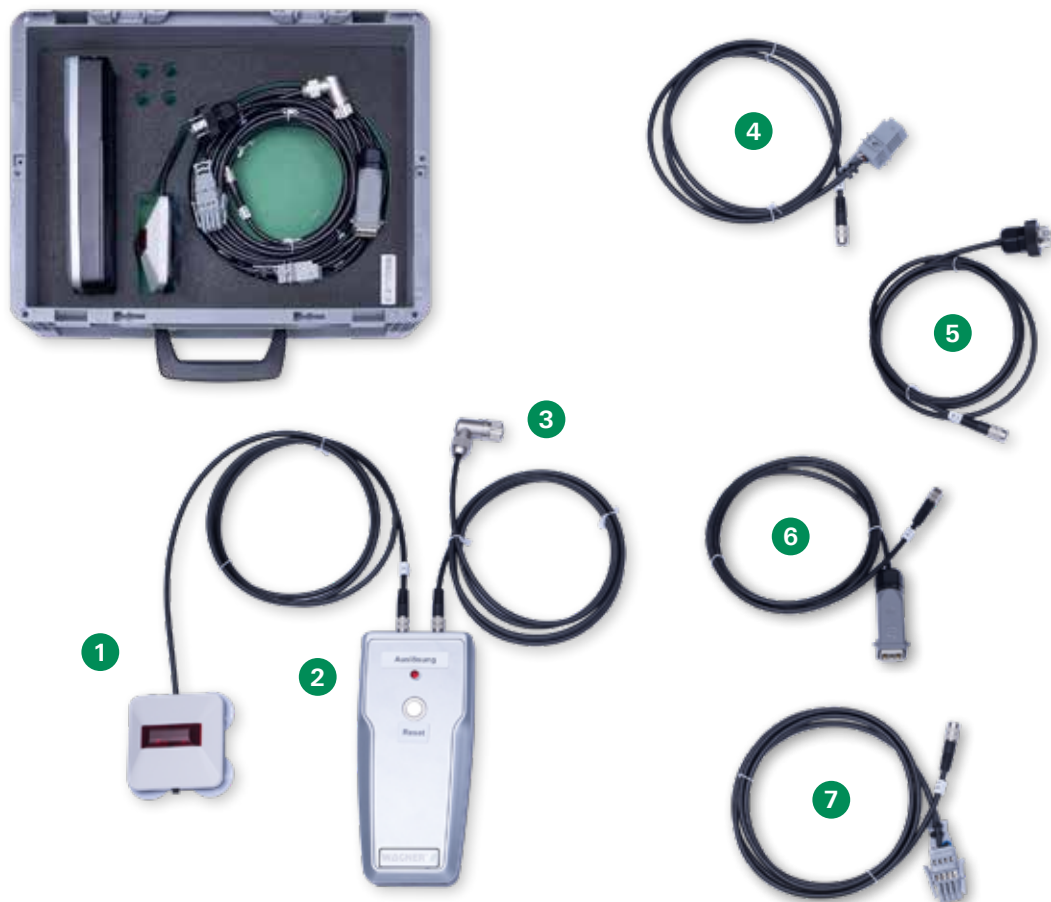

**Requirement:** 4x AA batteries

The test kit is used to check the signal transmission from a higher-level system (e.g. fire alarm control panel) to the electrical triggering devices of various fire-fighting or fire-extinguishing systems during commissioning or maintenance work. This involves checking whether the triggering signal is transmitted to the correct component without actually triggering the fire-fighting or extinguishing systems.

**Part No.: RL-50-0015**

- (1) Mobile LED remote display (1x)
- (2) Testing device (1x)

Different connection cables for different connector types:

- (3) B5 Phoenix connector, type PA M12-90 (1x)
- (4) B1 WAGO connector, type 769-F (1x)
- (5) B2 valve connector (1x)
- (6) B3 Harting connector, type Q5 (1x)
- (7) B4 WAGO connector, type 769-M (1x)



## ACCESSORIES



### Test plugs

- (1) **Part No.: RL-50-0275**  
Test plug set, 3.0 mm (12x)
- Part No.: RL-50-0276**  
Test plug set, 4.0 mm (12x)
- (2) **Part No.: RL-50-0018**  
Test plug for air filter (1x)

### Cleaning brushes

- (3) **Part No.: RL-50-0004**  
Special cleaning brushes  
2.0/3.0/4.0 mm (2x each)
- Part No.: RL-50-0020**  
Special cleaning brushes  
3.0 mm (6x)
- Part No.: RL-50-0025**  
Special cleaning brushes  
4.0 mm (6x)

### Test adapter

- (4) **Part No.: RL-50-0011**  
Test adapter, type A (2x)
- Harting connector, type Q5
- (5) **Part No.: RL-50-0012**  
Test adapter, type B (2x)
- WAGO connector, type 769-M
- (6) **Part No.: RL-50-0013**  
Test adapter, type C (5x)
- Valve connector
- (7) **Part No.: RL-50-0014**  
Test adapter, type D (2x)
- WAGO connector, type 769-F
- (8) **Part No.: RL-50-0022**  
Test adapter, type E (2x)
- Phoenix connector, type PA  
M12-90

### Fog generator FlowCheck

- (9) **Part No.: RL-50-0030**  
Replacement battery  
FlowCheck (1x)
- Fog generator FlowCheck  
incl. battery (1x)
- Charger FlowCheck (1x)
- Country adapter (1x)
- Charger for motor vehicle (1x)
- Replacement fog cartridges (1x)
- Replacement hose unit fog  
generator (2x)

### Diagnostic tool

- (10) **Part No.: RL-50-0562**  
DIAG 3/x diagnostic tool,  
software included (1x)
- USB cable for DIAG-Tool (1x)
- Hook for fastening the diagnostic  
tools (2x)

## SPARE PARTS



### Filter systems

- (1) **Part No.: RL-50-3580**  
Sensor air filter  
TITANUS MICRO-SENS® (10x)
- (2) **Part No.: RL-50-6021**  
Replacement kit for air filter  
inserts Rail (1x)
- (3) **Part No.: RL-50-6050**  
Air filter replacement cartridge  
(1x)

### Consumables for test tools

- (4) **Part No.: RL-50-0009**  
Replacement hose unit  
FlowCheck (1x)
- (5) **Part No.: RL-50-0006**  
Replacement fog cartridges  
FlowCheck (3x)
- (6) **Part No.: RL-10-1000**  
Test aerosol – WAGNER (1x)



# WAGNER Rail Serves Customers Worldwide



---

## WAGNER Rail GmbH

Hans-Pinsel-Straße 9b  
85540 Haar, Germany  
Phone: +49 89 450551 0  
[info@wagner-rail.com](mailto:info@wagner-rail.com)



---

Find your personal contact at  
[www.wagner-rail.com](http://www.wagner-rail.com)



---

WAGNER sets standards in fire protection – with tailor-made innovative solutions that fully meet the protection targets of operators and system houses.

---

### Very early fire detection systems

---

#### Fire fighting

---

#### Fire extinguishing

BETTER SOLUTIONS IN FIRE PROTECTION

**WAGNER®**